

BRUCE MATHER
INDEPENDENT ESTATE AGENT



West End Road
Benington, Boston, PE22 0EL
Price Guide £498,700



West End Road

Benington, Boston, PE22 0EL

Westthorpe House is a special country residence with over 6,700 square foot of house and buildings. This magnificent four bedroom, three reception room house has space to spare with an abundance of out buildings, crying out to be utilized for a business STPP. This family home is in reasonable condition, but dated, so room for improvement, and to add your own touch. The house sits on 0.7 acre (sts) formal garden. The house backs onto a nursery, is located approximately 6 miles out of Boston and less than 3 miles to the coast. A chain free sale!





Floor Plan

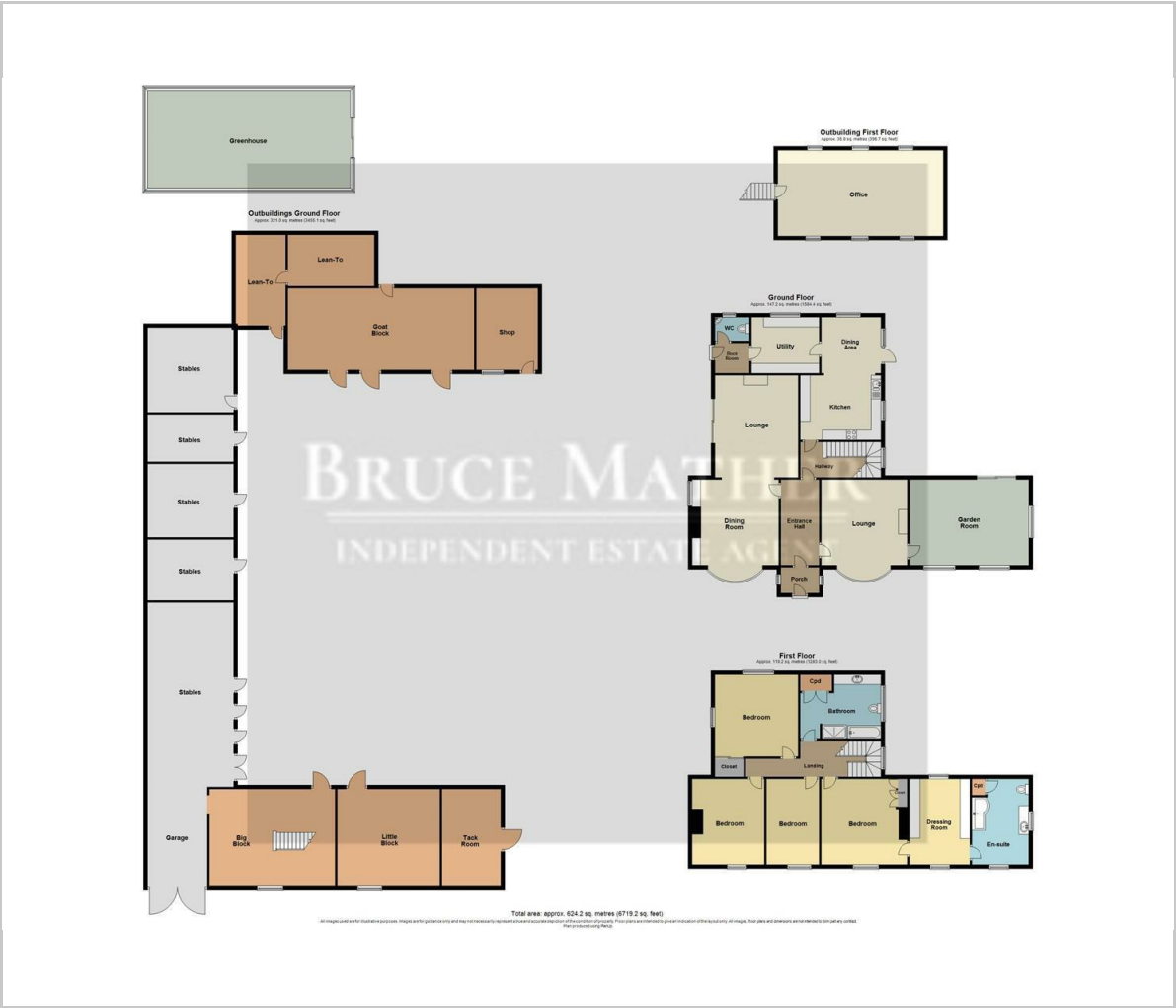

Viewing

Please contact our Boston Residential Office on 01205 360 387 if you wish to arrange a viewing appointment for this property or require further information.

These particulars, whilst believed to be accurate are set out as a general outline only for guidance and do not constitute any part of an offer or contract. Intending purchasers should not rely on them as statements of representation of fact, but must satisfy themselves by inspection or otherwise as to their accuracy. No person in this firms employment has the authority to make or give any representation or warranty in respect of the property.

6 Pump Square, Boston, Lincs, PE21 6QW
Tel: 01205 360 387 Email: sales@brucemather.co.uk brucemather.co.uk

Area Map



Energy Efficiency Graph

